

Assisted Living

at Edgewood
Park Place



Experience comfort, care, and convenience under one roof - your home!

Edgewood offers customizable services based on each resident's needs. We also provide:

- 24-hour staffing
- Three delicious meals & snacks each day
- Housekeeping, laundry & linen services
- Utilities
- CarePredict emergency pendant system
- Activities, outings, & social programs
- Coordination of transportation to appointments

Service Packages

To simplify pricing structures, we offer four service-level packages.

Each resident's care plan is personalized to their needs and based on their overall need for daily assistance and acuity. The service packages vary and will be established by an RN (or designee as determined per state regulations) who completes a total resident evaluation before move-in. Packages may include but are not limited to services such as medication management, hygiene-related care such as dressing, bathing, and grooming, oversight and monitoring of blood pressure, blood sugar, weight, and other daily vitals, and help to and from meals.

Level 1	\$800
Level 2	\$1,400
Level 3	\$2,000
Level 4	\$2,600

Apartment Rates

Floorplans may vary.

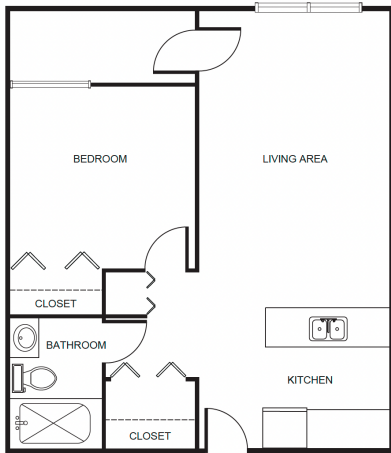

One Bedroom starting at\$4,950

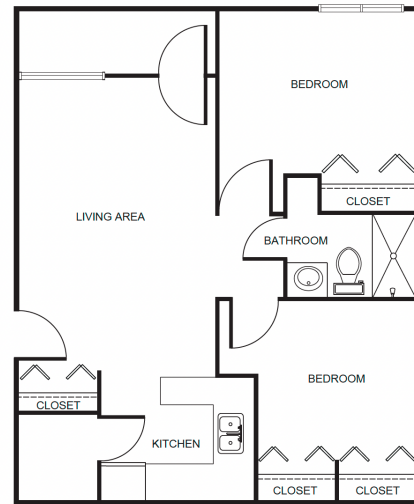

Two Bedroom starting at\$5,925

Additional Rates

Community Service Fee (non-refundable)	\$1,000
Assisted Plus starting at	\$500
Comfort Care Plus starting at	\$500
Second Person	\$1,050

Ask about our short-term stay rates and availability!